

## ◆ 选型 Type Selection

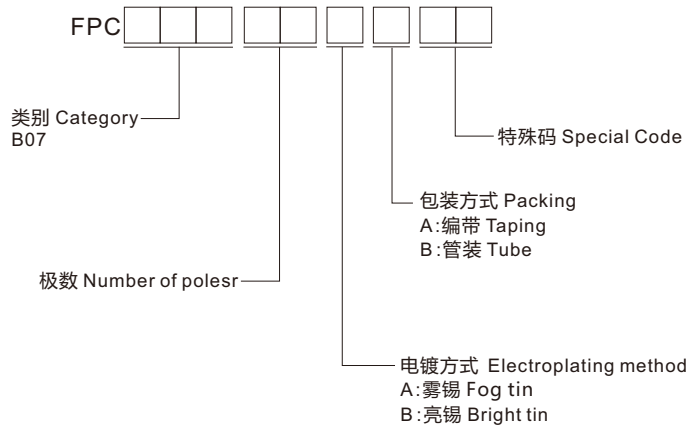

## ◆ 图 表 Diagram

- 0.5掀盖下接H=1.5

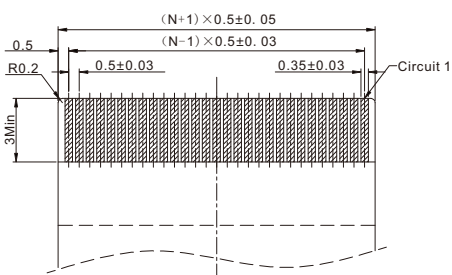
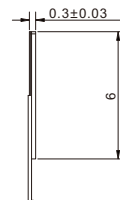
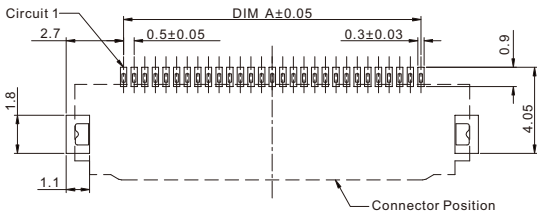
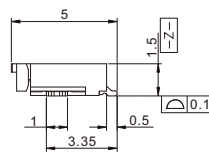
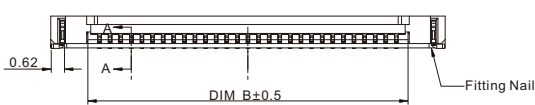
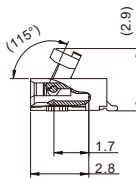
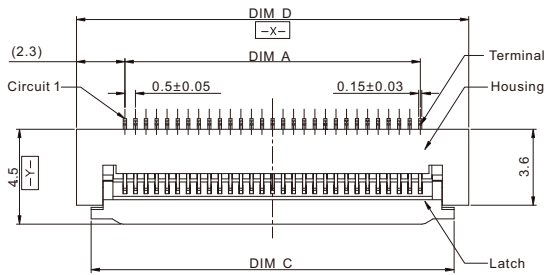

## ◆ 规格 Specifications

- 极数 Number of poles: 4~60
- 工作温度 Working Temperature: -40°C~+85°C
- 额定电压 (最大) Voltage rating(max): 1250V, AC
- 接触电阻 Contact resistance: ≤0.02Ω
- 绝缘电阻 Insulation resistance: ≥100MΩ
- 目前评级 Current rating: 1.0A
- 耐压 Withstand voltage: 250VAC(rms)

## ◆ 材质 Material

- 端子 Terminal: 铜合金 Copper Alloy
- 外壳 Housing: LCP

CKTS	尺寸 Size(mm)			
	DIM A	DIM B	DIM C	DIM D
4	1.50	2.60	4.70	6.10
5	2.00	3.10	5.20	6.60
6	2.50	3.60	5.70	7.10
7	3.00	4.10	6.20	7.60
8	3.50	4.60	6.70	8.10
9	4.00	5.10	7.20	8.60
10	4.50	5.60	7.70	9.10
.....	.....	.....	.....	.....